

# Stellos Low Voltage Halogen

# 1047 1048 1049 1052

## Adjustable

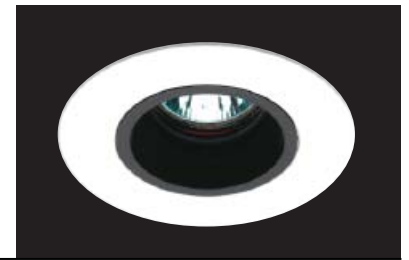
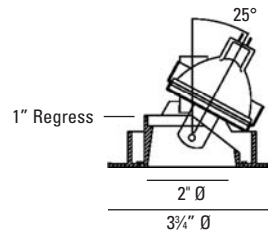

### LUMINAIRE INFORMATION

#### APPLICATION:

Accent luminaire for Residential, Commercial, Retail or Hospitality environments.

#### MATERIALS:

Trim: Die cast aluminum with torsion spring mounting.

**1047** - Chrome Cone

**1048** - Black Cone

**1049** - White Cone

**1052** - Vertical Groove Black Baffle

Lens: Clear

**LAMP:** (not included) When using IR lamps, 37W Max.

(1) 50W Max. MR16 GU5.3.

#### VOLTAGE:

Specify 120V or 277V.

#### ADJUSTMENT:

360° horizontal and 25° vertical tilt.

#### TRANSFORMER:

Low voltage solid state electronic.

Note: Due to transformer / dimmer match some dimmers may cause transformer hum. Check with dimmer manufacturer for suitability.

#### CEILING CUT OUT:

3 3/8" Ø

#### LISTINGS:

Dry/damp location.



IC/Airtight housing meets Washington state airflow requirement and ASTM E283. IBEW union made.

#### NOTES:

- Maximum ceiling thickness 1 inch. Consult factory for other ceiling conditions.
- Maximum 2 lens options (size A).

#### PHOTOMETRICS:

Distribution chart

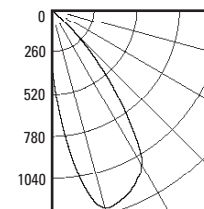

LTL No.: 13826.ies  
50W MR16 GU5.3 40°  
(tilted 25°)  
Clear lens  
58.8% Efficiency

### HOUSING INFORMATION

New Construction  
**325NC**

IC/Airtight  
**325IC**

Remote Transformer  
**325RM**

Retrofit  
**325RT-35** (35W max.)

Retrofit  
**325RT-50**

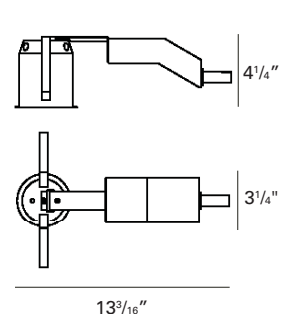
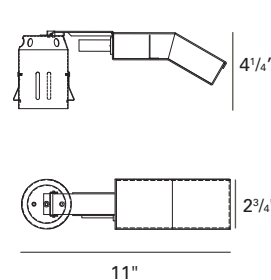
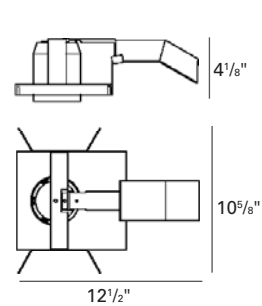
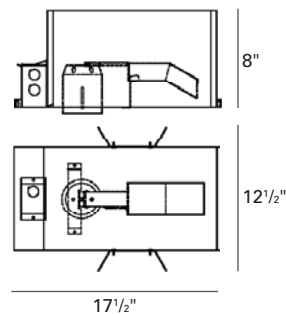
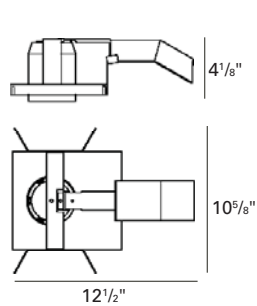

### HOW TO SPECIFY

| Trim   | Finish   | Housing  | Voltage                            | Accessories  |
|--|--|--|------------------------------------|--|
| <p><b>1047</b> - Chrome Cone<br/><b>1048</b> - Black Cone<br/><b>1049</b> - White Cone<br/><b>1052</b> - Vertical Groove Black Baffle</p> <p>Stellos<br/>Adjustable,<br/>50W Max. MR16 GU5.3</p> | <p><b>01</b> - Polished Chrome<br/><b>07</b> - Brushed Aluminum<br/><b>10</b> - White<br/><b>21</b> - Black<br/><b>28</b> - Metalized Grey</p> | <p><b>325NC</b> - New Construction<br/><b>325IC</b> - IC/Airtight<br/><b>325RM</b> - Remote Transformer<br/><b>325RT-35</b> - Retrofit (35W max.)<br/><b>325RT-50</b> - Retrofit</p> | <p><b>120V</b><br/><b>277V</b></p> | <p><b>8177A</b> - Hex Cell Louver<br/><b>9143A</b> - Frosted Lens<br/><b>9153A</b> - Anti UV Filter<br/><b>9155A</b> - Linear Spread Lens<br/><b>9156A</b> - Prismatic Spread Lens<br/><b>9157A</b> - Solite Lens<br/><b>9199A</b> - Frosted Borosilicate Lens<br/><b>ER</b> - Emergency Relay</p> |