

Stellos Low Voltage Halogen

Shallow Regress Adjustable

2280

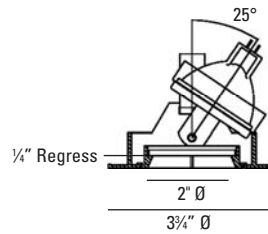

LUMINAIRE INFORMATION

APPLICATION:

Accent luminaire for Residential, Commercial, Retail or Hospitality environments.

MATERIALS:

Trim: Die cast aluminum with torsion spring mounting.
Lens: Clear

LAMP: (not included) When using IR lamps, 37W Max.
(1) 50W Max. MR16 GU5.3.

VOLTAGE:

Specify 120V or 277V.

TRANSFORMER:

Low voltage solid state electronic.

Note: Due to transformer / dimmer match some dimmers may cause transformer hum. Check with dimmer manufacturer for suitability.

ADJUSTMENT:

360° horizontal and 25° vertical tilt.

CEILING CUT OUT:

3 3/8" Ø

LISTINGS:

Dry/damp/wet under cover ceiling location.



IC/Airtight housing meets Washington state airflow requirement and ASTM E283.
IBEW union made.

NOTES:

- Maximum ceiling thickness 1 inch.
Consult factory for other ceiling conditions.
- Maximum 2 lens options (size B).

PHOTOMETRICS:

Distribution chart

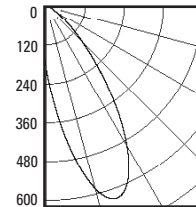

LTL No.: 13823ies
50W MR16 GU5.3 36°
(tilted 25°)
Frosted lens
54.8% Efficiency

HOUSING INFORMATION

New Construction
325NC

IC/Airtight
325IC

Remote Transformer
325RM

Retrofit
325RT-35 (35W max.)

Retrofit
325RT-50

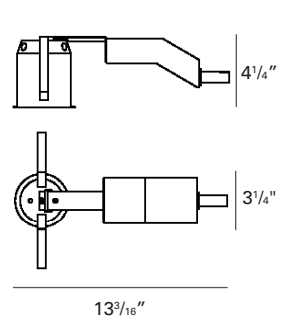
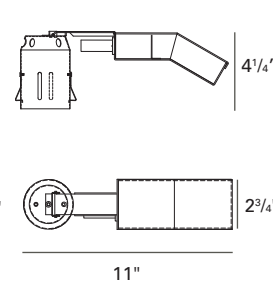
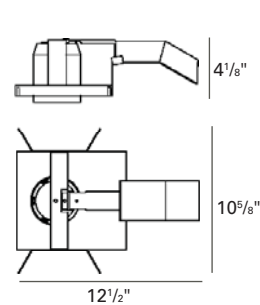
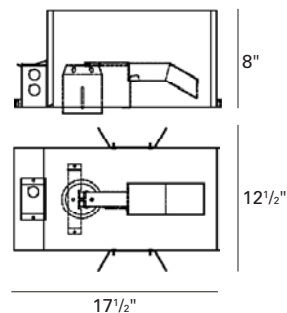
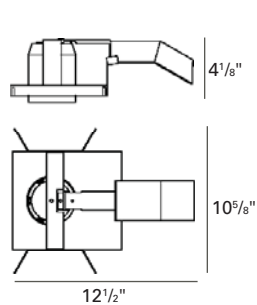

HOW TO SPECIFY

Trim	Finish	Housing	Voltage	Accessories
2280				
2280 Stellos Shallow Regress Adjustable, 50W Max. MR16 GU5.3	01 - Polished Chrome 07 - Brushed Aluminum 10 - White 21 - Black 28 - Metalized Grey	325NC - New Construction 325IC - IC/Airtight 325RM - Remote Transformer 325RT-35 - Retrofit (35W max.) 325RT-50 - Retrofit	120V 277V	8177B - Hex Cell Louver 9143B - Frosted Lens 9153B - Anti UV Filter 9155B - Linear Spread Lens 9156B - Prismatic Spread Lens 9157B - Solite Lens 9199B - Frosted Borosilicate Lens ER - Emergency Relay