

BEVEL® Trimless Metal Halide

2599

Adjustable 45°

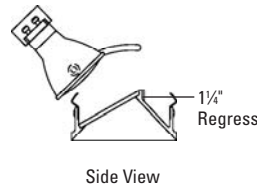
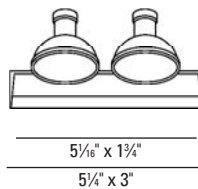

LUMINAIRE INFORMATION

APPLICATION:

Accent luminaire for Residential, Commercial, Retail or Hospitality environments.

MATERIALS:

Trim: Die cast aluminum with torsion spring mounting.
 Housing: All-Ways Square™ housing allows alignment of rectangular aperture (up to 30° rotation) after housing installation and prior to finish ceiling installation. Patent pending. Fabricated of 20 ga. galvanized steel with thru wire J-box, 4 in 4 out at min. 90°C, #12 AGW thru branch circuit wiring.
 Housing and trim supplied as one complete unit.
 Trim Lens: Frosted

LAMP: (not included)

(2) 20W or 39W MHMR16 GX10.

MOUNTING:

Butterfly brackets and adjustable nailer bars with integral nails provided. Nailer bars are extendible from 14" to 24" centers.

ADJUSTMENT:

(2) Hot aiming self locking rack and pinion 45° vertical adjustment and 15° tilt. Slide lock tab for locking horizontal rotation at 180° increments.

VOLTAGE:

Specify 120V or 277V.

BALLAST:

Solid state electronic.
 Note: Due to ballast / dimmer match some dimmers may cause ballast hum. Check with dimmer manufacturer for suitability.

CEILING CUT OUT:

3 1/2" x 5 1/16"

LISTINGS:

Dry/damp location.



IBEW union made.

NOTES:

- Housing included with trim.
- Maximum ceiling thickness 1 inch. Consult factory for other ceiling conditions.
- For drywall installation only.
- Not for use with acoustical ceilings.
- Maximum Millwork thickness 1 inch. Consult factory for other ceiling conditions.
- Maximum 1 lens option.
- Not for use with ES16 lamps

PHOTOMETRICS:

Distribution chart

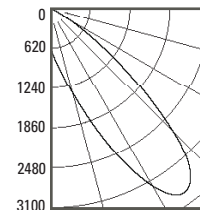

LTL No.: 14576.ies
(2) 39W MHMR16
 GX10 25° (tilted 45°)
 Frosted lens - 50.9% Efficiency
 Solite lens - 57% Efficiency

Distribution chart

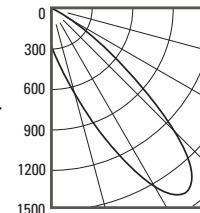

LTL No.: 17150.ies
(2) 20W MHMR16
 GX10 25° (tilted 45°)
 Frosted lens - 50.9% Efficiency
 Solite lens - 57% Efficiency

HOUSING INFORMATION

New Construction

FL926-A (20W)

FL460X-A (39W)

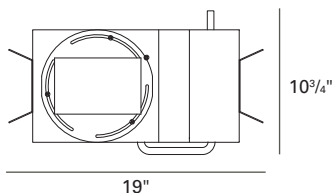
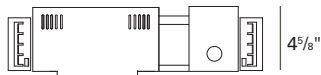

Millwork

FL926-A-ML (20W)

FL460X-A-ML (39W)

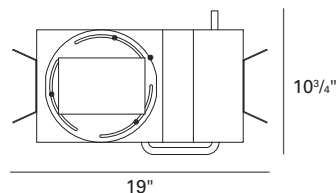
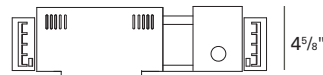

ORDERING INFORMATION

Trim	Finish	Trim Lens*	Housing	Voltage	Accessories
2599	10 - White	B - Borosilicate Clear Lens	20W MHMR16	120V	CB27 - 27" C-Channel Bars
Bevel Trimless	21 - Black	C - Clear Lens	FL926-A - New Construction	277V	CB52 - 52" C-Channel Bars
Adjustable 45°, (2) 20W or 39W MHMR16	28 - Metalized Grey	F - Frosted Lens	FL926-A-ML - Millwork		ACCESSORY HOLDER - Consult Factory
		L - Linear Spread Lens	39W MHMR16		
		P - Prismatic Lens	FL460X-A - New Construction		
		S - Solite	FL460X-A-ML - Millwork		
		U - Anti UV Filter			

*Frosted is standard unless option is specified

How to Specify	2599	Finish	Trim Lens	Housing	Voltage	Accessories
	Trim	Finish	Trim Lens	Housing	Voltage	Accessories



USA Illumination™
 www.usaillumination.com
 info@usaillumination.com

1126 River Road
 New Windsor, NY 12553

T 845-565-8500
 F 845-561-1130

©2009, USAI, LLC.
 All rights reserved.
 All designs protected by copyright.