

# BEVEL® Trimless Low Voltage Halogen

# 9004

## Downlight

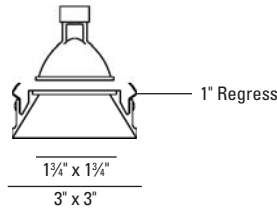

### LUMINAIRE INFORMATION

#### APPLICATION:

Accent luminaire for Residential, Commercial, Retail or Hospitality environments.

#### MATERIALS:

Trim: Die cast aluminum with mounting clips.  
 Housing: All-Ways Square™ housing allows alignment of square aperture (up to 45° rotation) after housing installation and prior to finish ceiling installation. Patent pending. Fabricated of 20 ga. galvanized steel with thru wire J-box, 2 in 2 out (4 in 4 out for IC/ Airtight) at min. 90°C, #12 AGW thru branch circuit wiring. Housing and trim supplied as one complete unit.  
 Trim Lens: Frosted

**LAMP:** (not included) When using IR lamps, 37W Max.

New Construction / Chicago Plenum / Millwork:

(1) 71W max. MR16 GU5.3

IC/Airtight: (1) 50W max. MR16 GU5.3

#### MOUNTING:

Butterfly brackets and adjustable nailer bars with integral nails provided. Nailer bars are extendible from 14" to 24" centers.

#### VOLTAGE:

Specify 120V, 277V or 347V.

347V is for New Construction housing only.

#### TRANSFORMER:

Low voltage magnetic toroidal HPF. Low voltage solid state electronic optionally available (consult factory).

Note: Due to transformer / dimmer match some dimmers may cause transformer hum. Check with dimmer manufacturer for suitability.

#### CEILING CUT OUT:

New Construction	3 1/2" x 3 1/2"
IC/ Airtight Ceiling	3 1/2" x 3 1/2"
Chicago Plenum	3 5/16" x 3 5/16"
Mill Work	3 5/16" x 3 5/16"

#### LISTINGS:

Dry/damp/ location.



IC/Airtight housing meets Washington state airflow requirement and ASTM E283. Chicago Plenum housing is Chicago Plenum rated.

IBEW union made.

#### NOTES:

- Housing included with trim.
- Maximum ceiling thickness 1 inch. Consult factory for other ceiling conditions.
- For drywall installation only.
- Not for use with acoustical ceilings.
- Maximum Millwork thickness 1 inch. Consult factory for other ceiling conditions.
- Maximum 1 lens option.

#### PHOTOMETRICS:

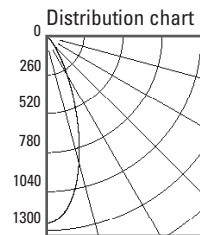

LTL No.: 13922.ies  
 71W MR16 GU5.3 40°  
 Frosted lens - 67.1% Efficiency  
 Solite lens - 84% Efficiency

Ft below	FC nadir	Dia. @ 50%
6.0	34.4	3.9
8.0	19.3	5.2
10.0	12.4	6.5
12.0	8.6	7.9
14.0	6.3	9.2
16.0	4.8	10.5

### HOUSING INFORMATION

New Construction - (71W)

**FL100-A**

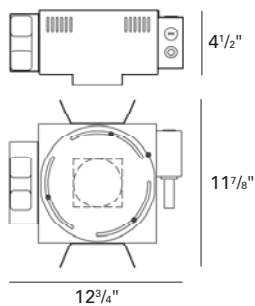

IC/Airtight - (50W)

**FL100-A-IC**

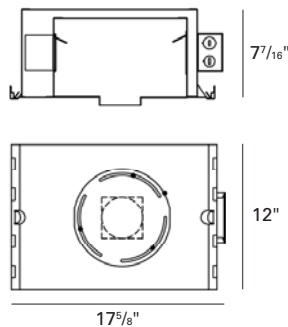

Chicago Plenum - (71W)

**FL100-A-CP**

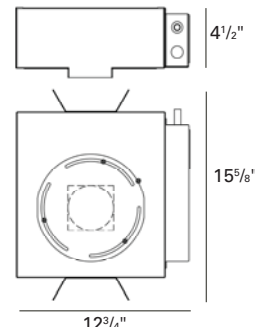

Millwork - (71W)

**FL100-A-ML**

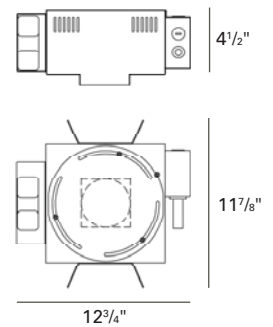

#### HOW TO SPECIFY

Trim	Finish	Trim Lens*	Housing	Voltage	Accessories
9004		*Frosted is standard unless option is specified			
<b>9004</b> Bevel Trimless Downlight, New Construction, Chicago Plenum and Millwork: 71W MR16 GU5.3 IC/Airtight: 50W MR16 GU5.3	10 - White 21 - Black 28 - Metalized Grey RAL - Special Color	B - Borosilicate Clear Lens C - Clear Lens F - Frosted Lens L - Linear Spread Lens P - Prismatic Lens S - Solite U - Anti UV Filter	FL100-A - New Construction FL100-A-IC - IC/Airtight FL100-A-CP - Chicago Plenum FL100-A-ML-XX - Millwork XX=Specify Color (10, 21, 28, RAL)	120V 277V 347V 347V for New Construction housing only	CB27 - 27" C-Channel Bars CB52 - 52" C-Channel Bars ER - Emergency Relay ACCESSORY HOLDER - Consult Factory



www.usalighting.com  
 info@usalighting.com

1126 River Road  
 New Windsor, NY 12553

T 845-565-8500  
 F 845-561-1130

©2011. USAI, LLC.  
 All rights reserved.  
 All designs protected by copyright.  
 Revised 08/25/2011