

BEVEL® Trimless Low Voltage

9008

Wall Wash

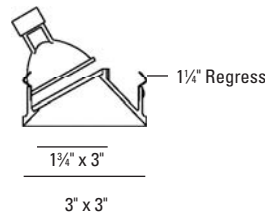

LUMINAIRE INFORMATION

APPLICATION:

Accent luminaire for Residential, Commercial, Retail or Hospitality environments.

MATERIALS:

Trim: Die cast aluminum with mounting clips.
 Housing: All-Ways Square™ housing allows alignment of square aperture (up to 45° rotation) after housing installation and prior to finish ceiling installation. Patent pending. Fabricated of 20 ga. galvanized steel with thru wire J-box, 2 in 2 out (4 in 4 out for IC/ Airtight) at min. 90°C, #12 AGW thru branch circuit wiring. Housing and trim supplied as one complete unit.
 Trim Lens: MultiTex proprietary molded low iron lens

LAMP: (not included) When using IR lamps, 37W Max.

New Construction / Chicago Plenum / Millwork:

(1) 71W max. MR16 GU5.3

IC/Airtight: (1) 50W max. MR16 GU5.3

MOUNTING:

Butterfly brackets and adjustable nailer bars with integral nails provided. Nailer bars are extendible from 14" to 24" centers.

VOLTAGE:

Specify 120V, 277V or 347V.
 347V is for New Construction housing only.

TRANSFORMER:

Low voltage magnetic toroidal HPF. Low voltage solid state electronic optionally available (consult factory).

Note: Due to transformer / dimmer match some dimmers may cause transformer hum. Check with dimmer manufacturer for suitability.

CEILING CUT OUT:

New Construction	
IC/ Airtight Ceiling	3 1/2" x 3 1/2"
Chicago Plenum	
Mill Work	3 5/16" x 3 5/16"

LISTINGS:

Dry/damp location.



IC/Airtight housing meets Washington state airflow requirement and ASTM E283. Chicago Plenum housing is Chicago Plenum rated. IBEW union made.

NOTES:

- Housing included with trim.
- Maximum ceiling thickness 1 inch. Consult factory for other ceiling conditions.
- For drywall installation only.
- Not for use with acoustical ceilings.
- Maximum millwork thickness 1 inch. Consult factory for other ceiling conditions.
- Maximum 1 lens option.

PHOTOMETRICS:

Distance From Ceiling in Feet	3' on center 3' from wall					
	0.5	3.4	3.3	3.1	3.3	3.4
1.5	9.0	8.9	8.6	8.9	9.0	
2.5	17.6	17.6	17.3	17.6	17.5	
3.5	23.8	24.0	23.9	24.0	23.7	
4.5	25.1	25.5	25.5	25.5	25.1	
5.5	23.4	23.8	23.8	23.8	23.5	
6.5	20.3	20.7	20.7	20.7	20.4	
7.5	16.8	17.1	17.1	17.0	16.8	

Lamp: 71W MR16 GU5.3, FL40, 1100 Lumens
 Reflectances: 0.8, 0.5, 0.2 LLF: 0.8
 Mounting Height: 8 FT 69.4% Efficiency



MultiTex™
 Glass lens with five different surface textures for maximum uniformity.

HOUSING INFORMATION

New Construction - (71W)

FL102-A

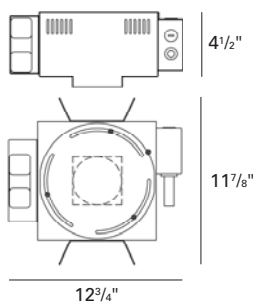

IC/Airtight - (50W)

FL102-A-IC

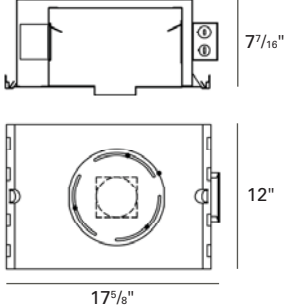

Chicago Plenum - (71W)

FL102-A-CP

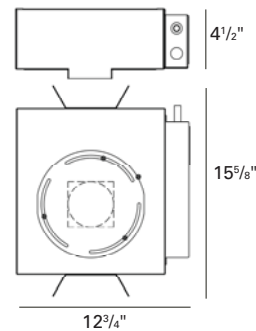

Millwork - (71W)

FL102-A-ML

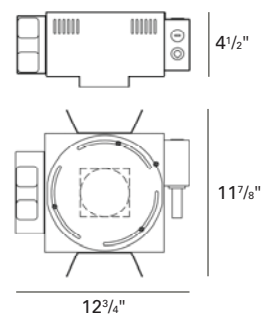

ORDERING INFORMATION

Trim	Finish	Housing	Voltage	Accessories
9008				
9008 Bevel Trimless Wall Wash, New Construction, Chicago Plenum and Millwork: 71W MR16 GU5.3 IC/Airtight: 50W MR16 GU5.3	10 - White 21 - Black 28 - Metalized Grey RAL - Special Color	FL102-A - New Construction FL102-A-IC - Insulated Ceiling FL102-A-CP - Chicago Plenum FL102-A-ML-XX - Millwork XX=Specify Color (10, 21, 28, RAL)	120V 277V 347V 347V for New Construction housing only	CB27 - 27" C-Channel Bars CB52 - 52" C-Channel Bars ER - Emergency Relay ACCESSORY HOLDER - Consult Factory