

Downlight

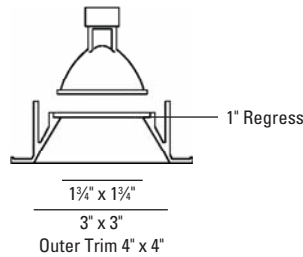

LUMINAIRE INFORMATION

APPLICATION:

Accent luminaire for Residential, Commercial, Retail or Hospitality environments.

MATERIALS:

Trim: Die cast aluminum with torsion spring mounting.
 Housing: All-Ways Square™ housing allows alignment of square aperture (up to 45° rotation) after housing installation and prior to finish ceiling installation. Patent pending. Fabricated of 20 ga. galvanized steel with thru wire J-box, 2 in 2 out (4 in 4 out for IC/Airtight) at min. 90°C, #12 AGW thru branch circuit wiring. Housing and trim supplied as one complete unit.
 Retrofit housing has end of run J-box.
 Trim Lens: Frosted

LAMP: (not included) When using IR lamps, 37W Max.

New Construction / Chicago Plenum: (1) 71W max. MR16 GU5.3
 IC/Airtight: (1) 50W max. MR16 GU5.3
 Retrofit: (1) 37W max. MR16 GU5.3

MOUNTING:

Butterfly brackets and adjustable nailer bars with integral nails provided. Nailer bars are extendible from 14" to 24" centers.

HOUSING INFORMATION

New Construction - (71W)

BL100-A

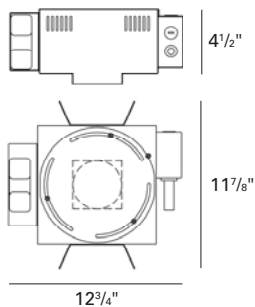

IC/Airtight - (50W)

BL100-A-IC

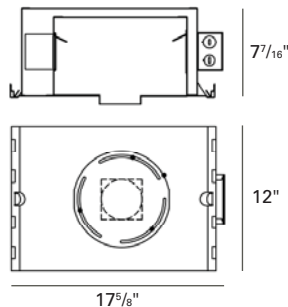

Retrofit - (37W)

BL100-A-RT

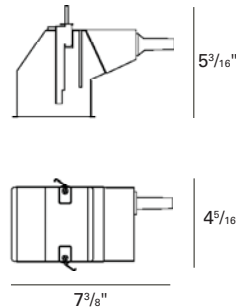

Chicago Plenum - (71W)

BL100-A-CP

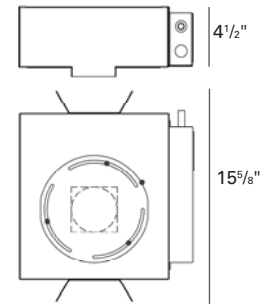

HOW TO SPECIFY

Trim	Finish	Trim Lens*	Housing	Voltage	Accessories
9343		*Frosted is standard unless option is specified			
9343 Bevel Trim Downlight, New Construction and Chicago Plenum: 71W MR16 GU5.3 IC/Airtight: 50W MR16 GU5.3 Retrofit: 37W MR16 GU5.3	10 - White 21 - Black 28 - Metalized Grey	B - Borosilicate Clear Lens C - Clear Lens F - Frosted Lens L - Linear Spread Lens P - Prismatic Lens S - Solite U - Anti UV Filter	BL100-A - New Construction BL100-A-IC - IC/Airtight BL100-A-RT - Retrofit (120V only) BL100-A-CP - Chicago Plenum	120V 277V 347V	CB27 - 27" C-Channel Bars CB52 - 52" C-Channel Bars ER - Emergency Relay ACCESSORY HOLDER - Consult Factory
120V not compatible with AFCI circuit when using RT housings. 347V for New Construction housing only.					

VOLTAGE:

Specify 120V, 277V or 347V.
 347V is for New Construction housing only.

TRANSFORMER:

Low voltage magnetic toroidal HPF. Low voltage solid state electronic optionally available (consult factory). Retrofit housing uses solid state electronic transformer only.
 Note: Due to transformer / dimmer match some dimmers may cause transformer hum. Check with dimmer manufacturer for suitability.

CEILING CUT OUT:

3 1/2" x 3 1/2"
 3 5/8" x 3 5/8" - Retrofit housing

LISTINGS:

Dry/damp/wet under covered ceiling.



IC/Airtight housing meets Washington state airflow requirement and ASTM E283. Chicago Plenum housing is Chicago Plenum rated.
 IBEW union made.

NOTES:

- Housing included with trim.
- Maximum ceiling thickness 1 inch. Consult factory for other ceiling conditions.
- Maximum 1 lens option.
- 120V not compatible with AFCI circuit when using RT housings.

PHOTOMETRICS:

Distribution chart

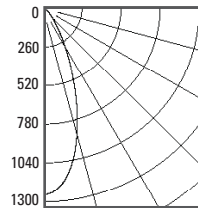

LTL No.: 13922.ies
 71W MR16 GU5.3 40°
 Frosted lens - 67.1% Efficiency
 Solite lens - 84% Efficiency

Ft below	FC nadir	Dia. @ 50%
6.0	34.4	3.9
8.0	19.3	5.2
10.0	12.4	6.5
12.0	8.6	7.9
14.0	6.3	9.2
16.0	4.8	10.5