

## Wall Wash

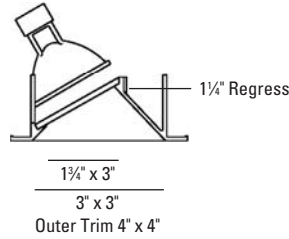

### LUMINAIRE INFORMATION

#### APPLICATION:

Accent luminaire for Residential, Commercial, Retail or Hospitality environments.

#### MATERIALS:

Trim: Die cast aluminum with torsion spring mounting.  
 Housing: All-Ways Square™ housing allows alignment of square aperture (up to 45° rotation) after housing installation and prior to finish ceiling installation. Patent pending. Fabricated of 20 ga. galvanized steel with thru wire J-box, 2 in 2 out (4 in 4 out for IC/Airtight) at min. 90°C, #12 AGW thru branch circuit wiring. Housing and trim supplied as one complete unit.  
 Retrofit housing has end of run J-box.

Trim Lens: MultiTex proprietary molded low iron lens.

#### LAMP: (not included) When using IR lamps, 37W Max.

New Construction / Chicago Plenum: (1) 71W max. MR16 GU5.3  
 IC/Airtight: (1) 50W max. MR16 GU5.3  
 Retrofit: (1) 37W max. MR16 GU5.3

#### MOUNTING:

Butterfly brackets and adjustable nailer bars with integral nails provided. Nailer bars are extendible from 14" to 24" centers.

#### VOLTAGE:

Specify 120V, 277V or 347V.  
 347V is for New Construction housing only.

#### TRANSFORMER:

Low voltage magnetic toroidal HPF. Low voltage solid state electronic optionally available (consult factory). Retrofit housing uses solid state electronic transformer only.  
 Note: Due to transformer / dimmer match some dimmers may cause transformer hum. Check with dimmer manufacturer for suitability.

#### CEILING CUT OUT:

3 1/2" x 3 1/2"  
 3 5/8" x 3 5/8" - Retrofit housing

#### LISTINGS:

Dry/damp/wet under covered ceiling.



IC/Airtight housing meets Washington state airflow requirement and ASTM E283. Chicago Plenum housing is Chicago Plenum rated.  
 IBEW union made.

#### NOTES:

- Housing included with trim.
- Maximum ceiling thickness 1 inch. Consult factory for other ceiling conditions.
- Maximum 1 lens option.
- 120V not compatible with AFCI circuit when using RT housings.

#### PHOTOMETRICS:

Distance From Ceiling in Feet	3' on center 3' from wall					
	0.5	3.4	3.3	3.1	3.3	3.4
1.5	9.0	8.9	8.6	8.9	9.0	
2.5	17.6	17.6	17.3	17.6	17.5	
3.5	23.8	24.0	23.9	24.0	23.7	
4.5	25.1	25.5	25.5	25.5	25.1	
5.5	23.4	23.8	23.8	23.8	23.5	
6.5	20.3	20.7	20.7	20.7	20.4	
7.5	16.8	17.1	17.1	17.0	16.8	

Lamp: 71W MR16 GU5.3, FL40, 1100 Lumens  
 Reflectances: 0.8, 0.5, 0.2

LLF: 0.8

Mounting Height: 8 FT  
 69.4% Efficiency

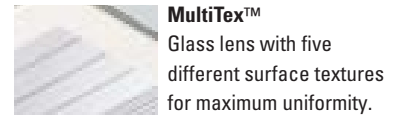

**MultiTex™**  
 Glass lens with five different surface textures for maximum uniformity.

### HOUSING INFORMATION

New Construction - (71W)

#### BL102-A

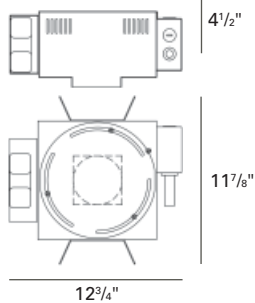

IC/Airtight - (50W)

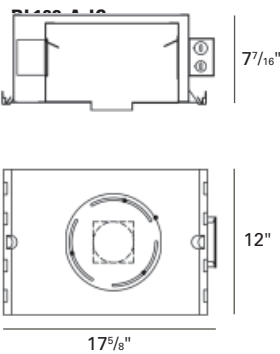

Retrofit - (37W)

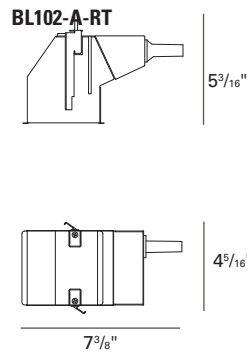

Chicago Plenum - (71W)

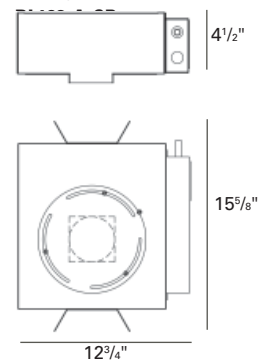

### HOW TO SPECIFY

Trim	Finish	Housing	Voltage	Accessories
9368				
<b>9368</b> Bevel Trim Wall Wash, New Construction and Chicago Plenum: 71W MR16 GU5.3 IC/Airtight: 50W MR16 GU5.3 Retrofit: 37W MR16 GU5.3	10 - White 21 - Black 28 - Metalized Grey	BL102-A - New Construction BL102-A-IC - IC/Airtight BL102-A-RT - Retrofit (120V only) BL102-A-CP - Chicago Plenum	120V 277V 347V	CB27 - 27" C-Channel Bars CB52 - 52" C-Channel Bars ER - Emergency Relay ACCESSORY HOLDER - Consult Factory
120V not compatible with AFCI circuit when using RT housings. 347V for New Construction housing only.				