

# Stellos Low Voltage Halogen

# 9750

## Adjustable

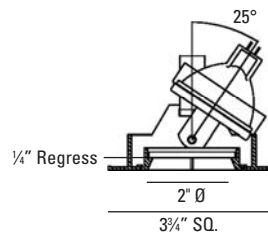

### LUMINAIRE INFORMATION

#### APPLICATION:

Accent luminaire for Residential, Commercial, Retail or Hospitality environments.

#### MATERIALS:

Trim: Die cast aluminum. Torsion spring mounting.  
Lens: Clear

**LAMP:** (not included) When using IR lamps, 37W Max.  
(1) 50W Max. MR16 GU5.3.

#### VOLTAGE:

Specify 120V or 277V.

#### TRANSFORMER:

Low voltage solid state electronic.

Note: Due to transformer / dimmer match some dimmers may cause transformer hum. Check with dimmer manufacturer for suitability.

#### ADJUSTMENT:

360° horizontal in 90° increments and 25° vertical tilt.

#### CEILING CUT OUT:

3<sup>3</sup>/<sub>8</sub>" Ø

#### LISTINGS:

Dry/damp/wet under cover ceiling location.



IC/Airtight housing meets Washington state airflow requirement and ASTM E283.  
IBEW union made.

#### NOTES:

- Maximum ceiling thickness 1 inch.  
Consult factory for other ceiling conditions.
- Maximum 2 lens options (size B).

#### PHOTOMETRICS:

##### Distribution chart

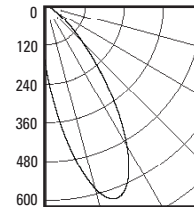

LTL No.: 13823ies  
50W MR16 GU5.3 36° (tilted 25°)  
Frosted lens  
54.8% Efficiency

### HOUSING INFORMATION

New Construction  
**325NC**

IC/Airtight  
**325IC**

Remote Transformer  
**325RM**

Retrofit  
**325RT-35** (35W max.)

Retrofit  
**325RT-50**

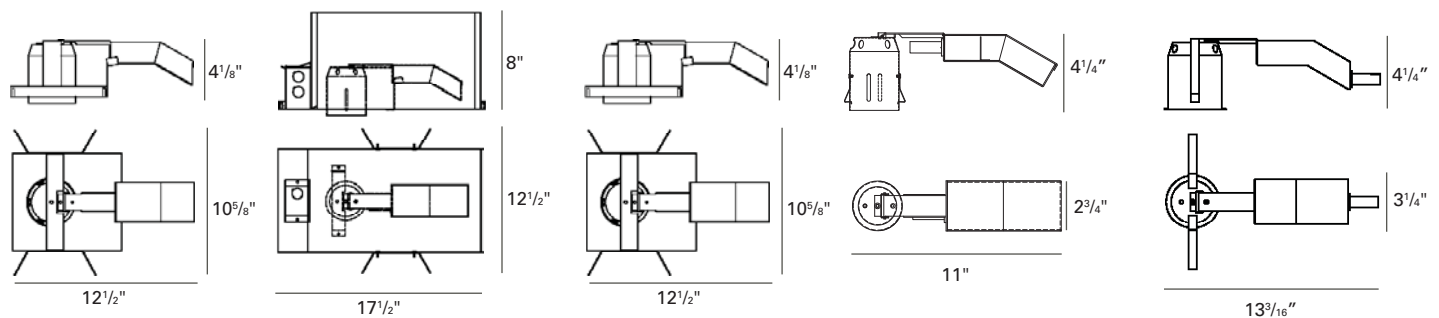

### HOW TO SPECIFY

Trim	Finish	Housing	Voltage	Accessories
9750				
<b>9750</b> Stellos Shallow Regress Adjustable, 50W Max. MR16 GU5.3	<b>10</b> - White <b>21</b> - Black <b>28</b> - Metalized Grey	<b>325NC</b> - New Construction <b>325IC</b> - IC/Airtight <b>325RM</b> - Remote Transformer <b>325RT-35</b> - Retrofit (35W max.) <b>325RT-50</b> - Retrofit	<b>120V</b> <b>277V</b>	<b>8177B</b> - Hex Cell Louver <b>9143B</b> - Frosted Lens <b>9153B</b> - Anti UV Filter <b>9155B</b> - Linear Spread Lens <b>9156B</b> - Prismatic Spread Lens <b>9157B</b> - Solite Lens <b>9199B</b> - Frosted Borosilicate Lens <b>ER</b> - Emergency Relay