

BEVEL® Trimless Low Voltage Halogen Downlight

9900

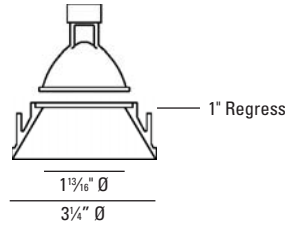

LUMINAIRE INFORMATION

APPLICATION:

Accent luminaire for Residential, Commercial, Retail or Hospitality environments.

MATERIALS:

Trim: Die cast aluminum with ball plunger mounting.
 Housing: Fabricated of 20 ga. galvanized steel with thru wire J-box, 2 in 2 out (4 in 4 out for IC/ Airtight) at min. 90°C, #12 AGW thru branch circuit wiring. Housing and trim supplied as one complete unit.
 Trim Lens: Solite

LAMP: (not included) When using IR lamps, 37W Max.

New Construction / Chicago Plenum: (1) 71W max. MR16 GU5.3
 IC/Airtight: (1) 50W max. MR16 GU5.3

MOUNTING:

Butterfly brackets and adjustable nailer bars with integral nails provided. Nailer bars are extendible from 14" to 24" centers.

VOLTAGE:

Specify 120V or 277V.

TRANSFORMER:

Low voltage magnetic toroidal HPF. Low voltage solid state electronic optionally available (consult factory).

Note: Due to transformer / dimmer match some dimmers may cause transformer hum. Check with dimmer manufacturer for suitability.

CEILING CUT OUT:

4 1/4" Ø

LISTINGS:

Dry/damp location



IC/Airtight housing meets Washington state airflow requirement and ASTM E283. Chicago Plenum housing is Chicago Plenum rated.
 IBEW union made.

NOTES:

- Housing included with trim.
- Maximum ceiling thickness 1 inch. Consult factory for other ceiling conditions.
- Maximum 1 lens option.
- For drywall installation only.
- Not for use with acoustical ceilings.

PHOTOMETRICS:

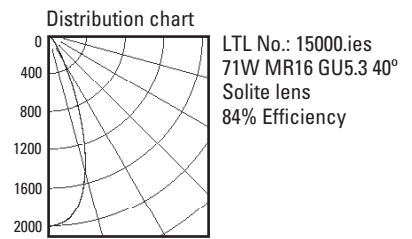

Ft below	FC nadir	Dia. @ 50%
6.0	55.8	4.0
8.0	31.4	5.4
10.0	20.1	6.7
12.0	14.0	8.0
14.0	10.2	9.3
16.0	7.8	10.7

HOUSING INFORMATION

New Construction - (71W)
RDL100-NC

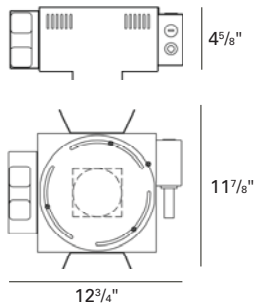

IC/Airtight - (50W)
RDL100-IC

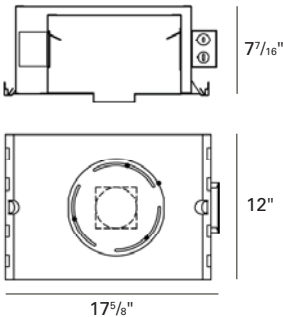

Chicago Plenum - (71W)
RDL100-CP

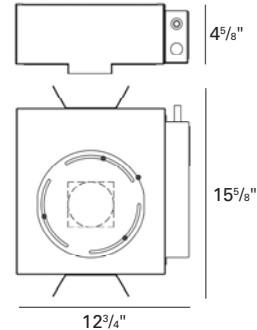

HOW TO SPECIFY

Trim	Finish	Trim Lens*	Housing	Voltage	Accessories
9900		*Solite is standard unless option is specified			
9900 Bevel Trimless Downlight, New Construction and Chicago Plenum: 71W MR16 GU5.3 IC/Airtight: 50W MR16 GU5.3	10 - White 21 - Black 28 - Metalized Grey	B - Borosilicate Clear Lens C - Clear Lens F - Frosted Lens L - Linear Spread Lens P - Prismatic Lens S - Solite U - Anti UV Filter	RDL100-NC - New Construction RDL100-IC - Insulated Ceiling RDL100-CP - Chicago Plenum	120V 277V	CB27 - 27" C-Channel Bars CB52 - 52" C-Channel Bars ER - Emergency Relay